

# REAR ASSEMBLY ELECTRIC

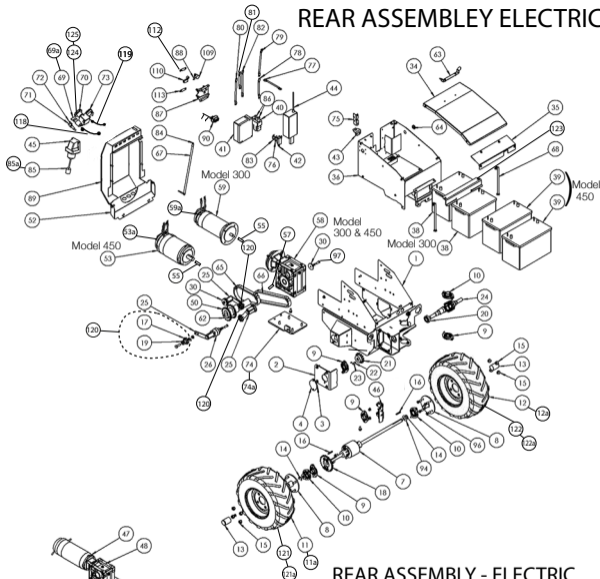

Serial Numbers  
B161 056 to B161 064

REAR ASSEMBLY - ELECTRIC  
800-18001-2  
18/02/20

## ELECTRIC REAR ASSEMBLY - PARTS LIST

ITEM NO.	PART NUMBER	DESCRIPTION	QTY	NOTES
1	101-03200	REAR CHASSIS WA	1	
2	101-99960	COVER BEARING REAR	1	
3	101-99943	SPACER BEARING COVER	1	
4	101-99942	PLATE BEARING COVER	1	
7	6-1300	DIFFERENTIAL AXLE REAR	1	
8	102-03100	HUB W.A.	2	
9	53-0120	BEARING BALL 19.05 bore mounted	4	SERIAL B161056 TO B161064
10	53-0110	BEARING BALL 25 bore mounted	3	
11	60-6509RHF	WHEEL ASSY 16X6.5X8	1	BENDI 300, UP TO B202299
11a	60-6509LHF	WHEEL ASSY 16X6.5X8	1	BENDI 450, UP TO B202299
12	60-6509LHF	WHEEL ASSY 16X6.50X8	1	BENDI 300, UP TO B202299
12a	60-6509RHF	WHEEL ASSY 16X6.50X8	1	BENDI 450, UP TO B202299
13	72-0400	MOULDING HUB COVER	2	
14	3-1061	CLIP E- 3/4" SHAFT	2	
15	8-3800	WHEEL NUT - 3/8" UNF	8	
16	21-1200	KEY 3/16"SQ X 40mm	2	
17	104-99926	COG 8T	3	UP TO B181628, THEN USE ITEM 120
18	104-99925	GEAR 22T	1	
19	53-0130	BEARING BALL 26x10x8	3	UP TO B181628, THEN USE ITEM 120
20	53-0170	BEARING BALL 25x47x12	1	
21	21-1500	COG 13T	1	
22	21-1600	KEY 6X6X25	1	
23	7-6031	SCREW GRUB M6 X 12	2	
24	21-0650	ASSEMBLY DRIVE JOINT	1	
25	2-1001	TENSIONER ASSEMBLY	3	
26	4-9031	WASHER 50X8.5X1.5 BZP	6	
30	102-99940	BOSS TENSIONER SUPPORT	2	
34	101-99964	TOP COVER BATTERY BOX	1	
35	101-99965	PRESSING ELECTRIC CENTRE COVER	1	
36	101-03800	BATTERY BOX W.A.	1	
38	70-3000	Battery 24 AGM	2	MODEL 300
39	70-3300	Battery 27 AGM	2	MODEL 450
40	70-0128	SOLINOID SWITCH	1	
41	70-0129	DC MOTOR CONTROLLER	1	
42	70-0130	FUSE HOLDER INLINE	1	
43	101-99966	BRAKE PIVOT BRACKET	1	
44	70-0134	BATTERY CHARGER	1	
45	70-0137	240V 16A SKT INLET	1	
46	101-99973	BEARING REAR BRACKET	1	
47	70-0800	MOTOR 1000W	1	SERIAL B161056-B161064
48	6-1500	GEARBOX 30:1 30MM BORE	1	SERIAL B161056-B161064
49	101-03500	BRACKET ELECTRIC GEARBOX	1	SERIAL B161056-B161064
35a	60-6509RHF	WHEEL ASSY 16X6.50X8	1	BENDI 450, UP TO B202299
40	53-0130	BEARING BALL 26x10x8	2	UP TO B181628, THEN USE ITEM 80
41	53-0170	BEARING BALL 25x47x12	1	
42	21-2100	CHAIN 5/8" FRONT	1	
43	2-1001	TENSIONER ASSEMBLY	2	
44	4-9021	WASHER 3/4" ID X 38 x 2.0	2	

## FRONT CHASSIS - PARTS LIST PETROL / DIESEL Cont'd

45	70-0137	240V 16A SKT INLET	1	
46	101-99973	BEARING REAR BRACKET	1	
47	70-0800	MOTOR 1000W	1	SERIAL B161056-B161064
48	6-1500	GEARBOX 30:1 30MM BORE	1	SERIAL B161056-B161064
49	101-03500	BRACKET ELECTRIC GEARBOX	1	SERIAL B161056-B161064
50	101-04200	OUTPUT SHAFT ELETRIC	1	SERIAL B161056-B161064
52	101-99963	PRESSING REAR COVER ELECTRIC	1	
53	70-01200	MOTOR 1300W	1	MODEL 450
53a	70-01201	BRAKE PACK MOTOR 1300W	1	MODEL 450
55	21-1800	KEY 8x7X40 LG	1	
57	21-1900	KEY 8x8x70 LG	1	
58	6-2100	GEARBOX TKM48B 71B5	1	MODEL 300
58	6-2200	GEARBOX TKM48B 90 B14	1	MODEL 450
59	70-01000	MOTOR 1000W	1	MODEL 300
59a	70-01001	BRAKE PACK MOTOR 1000W	1	MODEL 300
62	101-04300	OUTPUT SHAFT ELETRIC	1	
63	101-99967	BRACKET CABLE WRAP	1	
64	72-1600	GROMMET 20MM	1	
65	21-2200	CHAIN ELECTRIC REAR	1	
66	21-2400	CHAIN ELECTRIC CENTRE	1	
67	101-99969	BRAKE DISENGAGE LEVER	1	
68	9-10033	M10 X 220 COACHBOLT	2	
69	70-0136	IGNITION SWITCH	1	
69a	70-0150	IGNITION KEY	1	
70	70-0127	E STOP BUTTON ASSY	1	
71	70-0135	FUSE HOLDER	1	
72	70-0142	FUSE 10A ROUND	1	
73	70-0133	HOUR METER	1	
74	101-99972	BASE BRACKET GEARBOX	1	SERIAL NO. UP TO B202299
74a	101-04800	GBOX ADJUSTER PLATE WA	1	SERIAL NO. FROM B202300
75	101-99971	CABLE CLAMP BRACKET	1	
76	70-0131	FUSE INLINE 125A FLAT DIA6	1	1 FUSE FOR ALL
77	70-0121	POWER CABLE -VE 400MM 8/8	1	
78	70-0122	POWER CABLE +VE 650MM 8/6	1	
79	70-0123	POWER CABLE +VE 400MM 8/6	1	
80	70-0124	POWER CABLE -VE 600MM 8/6	1	
81	70-0125	POWER CABLE +VE 125MM 8/6	1	
82	70-0126	POWER CABLE +VE 850MM 8/6	1	
83	70-0132	FUSE INLINE 100A FLAT DIA6	1	
84	72-1100	PVC CAP RED DIA10 X 25 LONG	1	
85	70-0139	POWER CABLE UK PLUG	1	
85a	70-0152	POWER CABLE EURO PLUG	1	
86	72-1300	BOOT RA 16ID 8ID	2	
87	101-99970	BRACKET POTENTIOMETER	1	
88	101-99975	CLAMP LEVER POTENTIOMETER	1	
89	101-03900	MOTOR COVER WA	1	
90	70-0143	CABLE HARNESS	1	

## FRONT CHASSIS - PARTS LIST PETROL / DIESEL Cont'd

94	4-9021	WASHER 3/4" ID X 38 x 2.0	2	
96	7-10050	WHEEL STUD 3/8"X24UNF	8	
109	70-01405SP	POTENTIOMETER CURTIS CM4475 & HARNESS	1	
110	70-0141	MICROSWITCH ROLLER	1	
112	2-1010	SPRING EXT DEADMAN ELEC	1	
113	2-1014	SPRING EXT POTENTIOMETER	1	
118	70-0149	LEAD FUSE TO IGNITION	1	
119	70-0148	LEAD STOP SWITCH TO FUSE	1	
120	104-99926SP	COG/SLIPPER KIT	3	SERIAL NO FROM B181629
121	60-6609RHF	WHEEL ASSY 16X6.5X8	1	BENDI 300, FROM B202300
121a	60-6609LHF	WHEEL ASSY 16X6.5X8	1	BENDI 450, FROM B202300
122	60-6609LHF	WHEEL ASSY 16X6.50X8	1	BENDI 300, FROM B202300
122a	60-6609RHF	WHEEL ASSY 16X6.50X8	1	BENDI 450, FROM B202300
123	101-99946	BATTERY CLAMP	1	
124	70-0172	ISOLATION SWITCH	1	
125	70-0173	SWITCH LOCKOUT LEVER	1	